

# LUXORliving E1

Item no.: 4800542



Home and Building control  
LUXORliving

## Description

- 1-way flush-mounted actuator for electric heating LUXORliving
- Easy installation due to the compact housing
- For direct connection of electric heating with high switching capacity
- Integrated temperature controller can also be configured as an additional heater
- Additional stage function for simple control of a second heat generator
- 2 binary inputs for floating contacts such as buttons, switches, temperature sensor (I2)
- Integrated temperature monitoring for increased operating safety, e.g. in the event of overload
- The binary inputs are assigned to the dimming output as standard (function test before programming)
- Download of the installation software LUXORplug at <https://luxorliving.de/luxorplug>

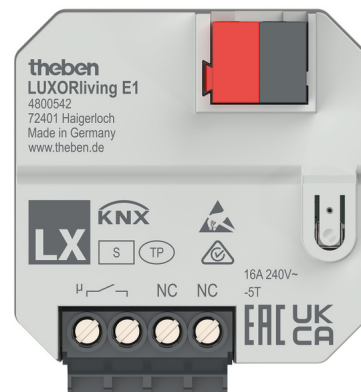

## Technical data

LUXORliving E1	
Operating voltage KNX	Bus voltage, $\leq 4$ mA
Installation type	Flush-mounted
Number of channels	1

LUXORliving E1	
Type of contact	16 A
Ambient temperature	-5°C ... 45°C

## Connection example

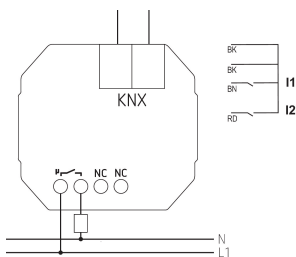

Subject to technical changes and misprints

additional information at: [www.theben.de/product/4800542](http://www.theben.de/product/4800542)

The load data are determined with exemplary selected illuminants and are therefore typical data due to the large number of available products.

# LUXORliving E1

Item no.: 4800542

theben

## Scale drawings

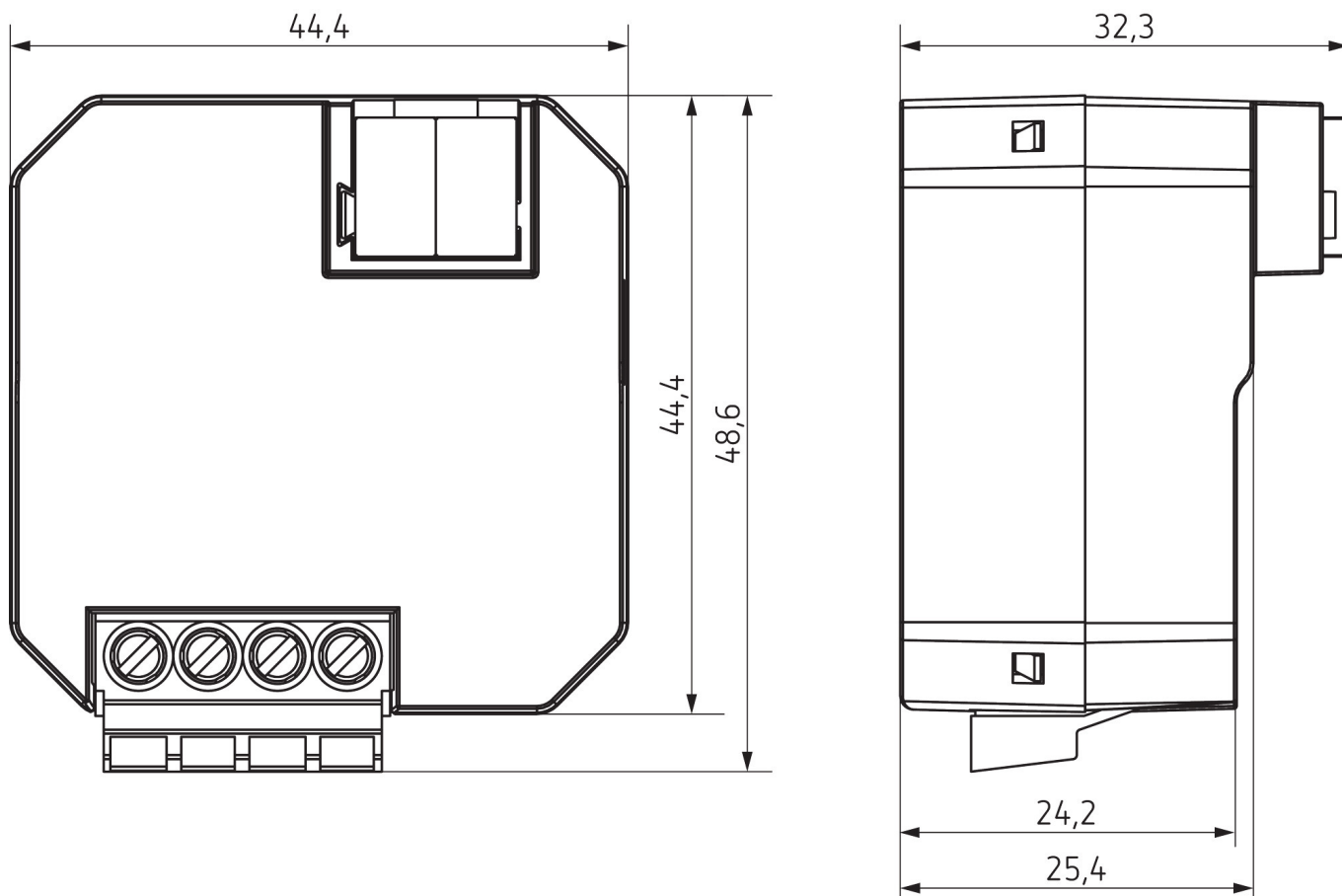

## Accessories

Temperature sensor  
Item no.: 9070321



Temperature sensor RAMSES IP  
65  
Item no.: 9070459



Flush-mounted temperature  
sensor  
Item no.: 9070496



Subject to technical changes and misprints

additional information at: [www.theben.de/product/4800542](http://www.theben.de/product/4800542)

The load data are determined with exemplary selected illuminants and are therefore typical data due to the large number of available products.